

Schaulaterne DIN SS

cylinder sight glass
DIN welding ends

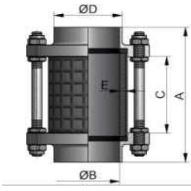

| Art. 61300- | | | | | | | | AISI 304/304L-1.4301/1.4307 | | | | AISI 316L-1.4404 | | | |
|-------------|-------|-------|-------|-------|-----|-------|--|-----------------------------|--------|----------|--------|------------------|--------|----------|---------|
| DN | A | B | C | D | E | Gew. | | Art.-Nr. | Preis | Art.-Nr. | Preis | Art.-Nr. | Preis | Art.-Nr. | Preis |
| | mm | mm | mm | mm | mm | kg | | bl. NBR | EUR | bl. NBR* | EUR | bl. NBR | EUR | bl. NBR* | EUR |
| 10 | 92,0 | 10,0 | 60,0 | 14,0 | 2,5 | 0,250 | | -010120C | 59,60 | -0101203 | 73,65 | -0103200 | 83,45 | -0103203 | 97,50 |
| 15 | 92,0 | 16,0 | 60,0 | 20,0 | 2,5 | 0,300 | | -015120C | 61,80 | -0151203 | 76,15 | -0153200 | 85,40 | -0153203 | 99,75 |
| 20 | 92,0 | 20,0 | 60,0 | 24,0 | 3,0 | 0,730 | | -020120C | 66,30 | -0201203 | 83,15 | -0203200 | 92,70 | -0203203 | 109,55 |
| 25 | 98,0 | 26,0 | 70,0 | 30,0 | 3,0 | 0,750 | | -025120C | 46,85 | -0251203 | 64,00 | -0253200 | 65,50 | -0253203 | 82,65 |
| 32 | 104,0 | 32,0 | 70,0 | 36,0 | 3,0 | 0,760 | | -032120C | 48,40 | -0321203 | 65,95 | -0323200 | 67,35 | -0323203 | 84,90 |
| 40 | 112,0 | 38,0 | 70,0 | 42,0 | 5,0 | 1,080 | | -040120C | 51,65 | -0401203 | 71,95 | -0403200 | 71,65 | -0403203 | 91,95 |
| 50 | 112,0 | 50,0 | 70,0 | 54,0 | 5,0 | 1,340 | | -050120C | 57,05 | -0501203 | 78,05 | -0503200 | 79,90 | -0503203 | 100,90 |
| 65 | 127,0 | 66,0 | 85,0 | 70,0 | 5,0 | 1,900 | | -065120C | 70,95 | -0651203 | 98,35 | -0653200 | 98,60 | -0653203 | 126,00 |
| 80 | 135,0 | 81,0 | 85,0 | 85,0 | 5,0 | 2,350 | | -080120C | 98,25 | -0801203 | 129,00 | -0803200 | 136,80 | -0803203 | 167,55 |
| 100 | 169,0 | 100,0 | 115,0 | 104,0 | 5,0 | 2,800 | | -100120C | 128,65 | -1001203 | 165,7 | -1003200 | 177,70 | -1003203 | 214,75 |
| 125 | 202,0 | 125,0 | 160,0 | 129,0 | 7,0 | 6,350 | | -125120C | 360,70 | -1251203 | 413,25 | -1203200 | 500,55 | -1203203 | 553,10 |
| 150 | 216,0 | 150,0 | 170,0 | 154,0 | 9,0 | 7,110 | | -150120C | 714,00 | -1501203 | 785,55 | -1503200 | 991,15 | -1503200 | 1062,70 |

* und Splitterschutz

* and safety screen

Schaulaterne DIN KG

cylinder sight glass
DIN liner/male

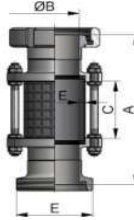

| Art. 61500- | | | | | | | | AISI 304/304L-1.4301/1.4307 | | | | AISI 316L-1.4404 | | | |
|-------------|-------|-------|-------|-----|-----------|--------|--|-----------------------------|---------|----------|---------|------------------|---------|----------|---------|
| DN | A | B | C | D | E | Gew. | | Art.-Nr. | Preis | Art.-Nr. | Preis | Art.-Nr. | Preis | Art.-Nr. | Preis |
| | mm | mm | mm | mm | mm | kg | | bl. NBR | EUR | bl. NBR* | EUR | bl. NBR | EUR | bl. NBR* | EUR |
| 10 | 122,0 | 10,0 | 60,0 | 2,5 | Rd28x1/8 | 0,380 | | -010120C | 87,75 | -0101203 | 101,80 | -0103200 | 115,40 | -0103203 | 129,45 |
| 15 | 122,0 | 16,0 | 60,0 | 2,5 | Rd34x1/8 | 0,450 | | -015120C | 89,25 | -0151203 | 103,60 | -0153200 | 124,55 | -0153203 | 138,90 |
| 20 | 124,0 | 20,0 | 60,0 | 3,0 | Rd44x1/6 | 0,690 | | -020120C | 96,85 | -0201203 | 113,70 | -0203200 | 134,90 | -0203203 | 151,75 |
| 25 | 142,0 | 26,0 | 70,0 | 3,0 | Rd52x1/6 | 1,020 | | -025120C | 73,60 | -0251203 | 90,75 | -0253200 | 102,75 | -0253203 | 119,90 |
| 32 | 154,0 | 32,0 | 70,0 | 3,0 | Rd58x1/6 | 1,250 | | -032120C | 80,15 | -0321203 | 97,70 | -0323200 | 112,05 | -0323203 | 129,60 |
| 40 | 164,0 | 38,0 | 70,0 | 5,0 | Rd65x1/6 | 1,670 | | -040120C | 85,35 | -0401203 | 105,65 | -0403200 | 119,15 | -0403203 | 139,45 |
| 50 | 168,0 | 50,0 | 70,0 | 5,0 | Rd78x1/6 | 2,170 | | -050120C | 93,60 | -0501203 | 114,60 | -0503200 | 131,95 | -0503203 | 152,95 |
| 65 | 191,0 | 66,0 | 85,0 | 5,0 | Rd95x1/6 | 3,260 | | -065120C | 122,15 | -0651203 | 149,55 | -0653200 | 172,05 | -0653203 | 199,45 |
| 80 | 209,0 | 81,0 | 85,0 | 5,0 | Rd110x1/4 | 3,710 | | -080120C | 169,60 | -0801203 | 200,35 | -0803200 | 236,65 | -0803203 | 267,40 |
| 100 | 257,0 | 100,0 | 115,0 | 5,0 | Rd130x1/4 | 5,100 | | -100120C | 235,65 | -1001203 | 272,70 | -1003200 | 328,15 | -1003203 | 365,20 |
| 125 | 270,0 | 125,0 | 160,0 | 7,0 | Rd160x1/4 | 9,500 | | -125120C | 548,55 | -1251203 | 601,10 | -1203200 | 764,30 | -1203203 | 816,85 |
| 150 | 290,0 | 150,0 | 170,0 | 9,0 | Rd190x1/4 | 11,300 | | -150120C | 1023,35 | -1501203 | 1094,90 | -1503200 | 1424,05 | -1503203 | 1495,60 |

* und Splitterschutz

* and safety screen

Schaulaterne Zoll SS

cylinder sight glass
(inch) welding ends

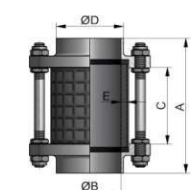

| Art. 61301- | | | | | | | | AISI 304/304L-1.4301/1.4307 | | | | AISI 316L-1.4404 | | | |
|-------------|-------|------|-------|-------|-----|-------|--|-----------------------------|--------|----------|--------|------------------|--------|----------|--------|
| DN | A | B | C | D | E | Gew. | | Art.-Nr. | Preis | Art.-Nr. | Preis | Art.-Nr. | Preis | Art.-Nr. | Preis |
| | mm | mm | mm | mm | mm | kg | | bl. NBR | EUR | bl. NBR* | EUR | bl. NBR | EUR | bl. NBR* | EUR |
| 1" | 96,0 | 23,3 | 70,0 | 28,0 | 3 | 0,750 | | -100120C | 47,30 | -1001203 | 64,45 | -1003200 | 66,15 | -1003203 | 83,30 |
| 1,5" | 110,0 | 35,1 | 70,0 | 41,0 | 5,0 | 1,080 | | -112120C | 52,20 | -1121203 | 72,50 | -1123200 | 72,35 | -1123203 | 92,65 |
| 2" | 110,0 | 47,8 | 70,0 | 54,0 | 5,0 | 1,340 | | -200120C | 57,60 | -2001203 | 78,60 | -2003200 | 80,70 | -2003203 | 101,70 |
| 2,5" | 125,0 | 60,5 | 85,0 | 68,0 | 5,0 | 1,900 | | -212120C | 71,65 | -2121203 | 99,05 | -2123200 | 99,60 | -2123203 | 127,00 |
| 3" | 133,0 | 72,8 | 85,0 | 78,1 | 5,0 | 2,350 | | -300120C | 99,25 | -3001203 | 130,00 | -3003200 | 138,15 | -3003203 | 168,90 |
| 4" | 167,0 | 97,6 | 115,0 | 103,6 | 5,0 | 2,800 | | -400120C | 129,90 | -4001203 | 166,95 | -4003200 | 179,45 | -4003203 | 216,50 |

* und Splitterschutz

* and safety screen

Glaszylinder

glas cylinder

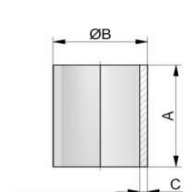

| Art. 61700- | | | | | | | Borosilikat / borosilicate | | |
|-------------|-------|-------|-----|----|---------|------|----------------------------|--|--------|
| DN | A | B | C | D | E | Gew. | Art.-Nr. | | Preis |
| | mm | mm | mm | mm | p (bar) | kg | | | EUR |
| 10 | 60,0 | 15,0 | 2,5 | | | 28 | -0100 | | 4,65 |
| 15 | 60,0 | 22,0 | 2,5 | | | 18 | -0150 | | 4,65 |
| 20 | 60,0 | 26,0 | 3,0 | | | 18 | -0200 | | 4,65 |
| 25 | 70,0 | 32,0 | 3,0 | | | 14 | -0250 | | 5,55 |
| 32 | 70,0 | 40,0 | 3,0 | | | 11 | -0320 | | 5,55 |
| 40 | 70,0 | 50,0 | 5,0 | | | 15 | -0400 | | 7,15 |
| 50 | 70,0 | 60,0 | 5,0 | | | 12 | -0500 | | 9,50 |
| 65 | 85,0 | 75,0 | 5,0 | | | 10 | -0650 | | 12,00 |
| 80 | 85,0 | 90,0 | 5,0 | | | 8 | -0800 | | 14,75 |
| 100 | 115,0 | 110,0 | 5,0 | | | 6 | -1000 | | 29,75 |
| 125 | 160,0 | 140,0 | 7,0 | | | 7 | -1250 | | 62,15 |
| 150 | 170,0 | 170,0 | 9,0 | | | 7 | -1500 | | 126,25 |

p: max. Betriebsdruck

p: max. pressure